



CHATTERTON | REES



1, 45 Thornton Avenue, London, SW2 4BD
Asking price £699,999





1, 45 Thornton Avenue

London, SW2 4BD

- Long lease
- Recently renovated
- Close to transport
- Wood floors
- Garden
- 2 bedrooms

A grand, two double bedroom lateral garden apartment in this stunning Victorian house on the very popular Thornton Avenue. The flat has been renovated to an extremely high standard by the current owners, it is offered in immaculate condition throughout.

Boasting landscaped gardens, at the front and back, two incredibly large double bedrooms, with high ceilings throughout. Storage in plenty and a stunning bathroom with bath and overhead shower. A beautiful kitchen and dining room with mod con appliances like boiling water tap and filtered water. The kitchen leads through to a semi open plan light and cosy reception room at the rear of the property, with crittall style doors leading through to a stunning garden.

Thornton Avenue is a popular residential road which leads to Emmanuel Road in Balham's Telford Park Estate. Both Balham mainline and underground station and Streatham Hill overground station are within easy reach as are the vast array of shops, bars and restaurants local to the area. The green open spaces of Tooting Bec Common are also close by.

Asking price £699,999



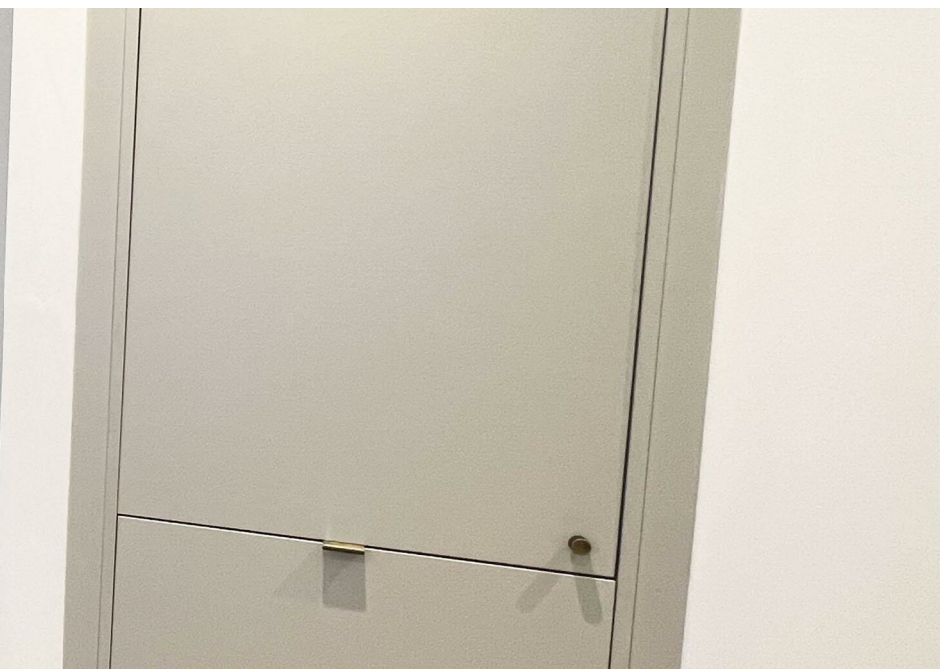



Floor Plans

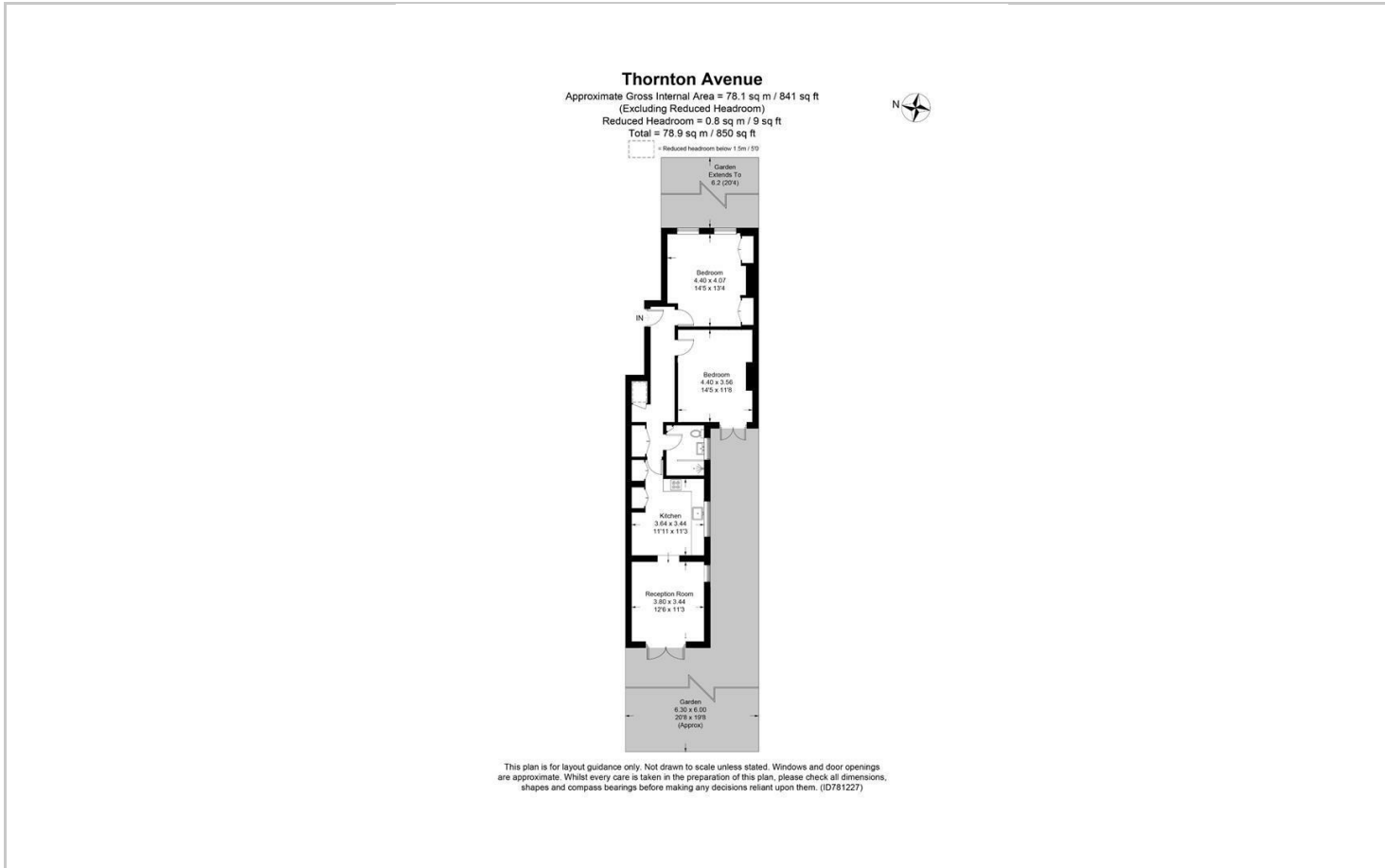

Location Map

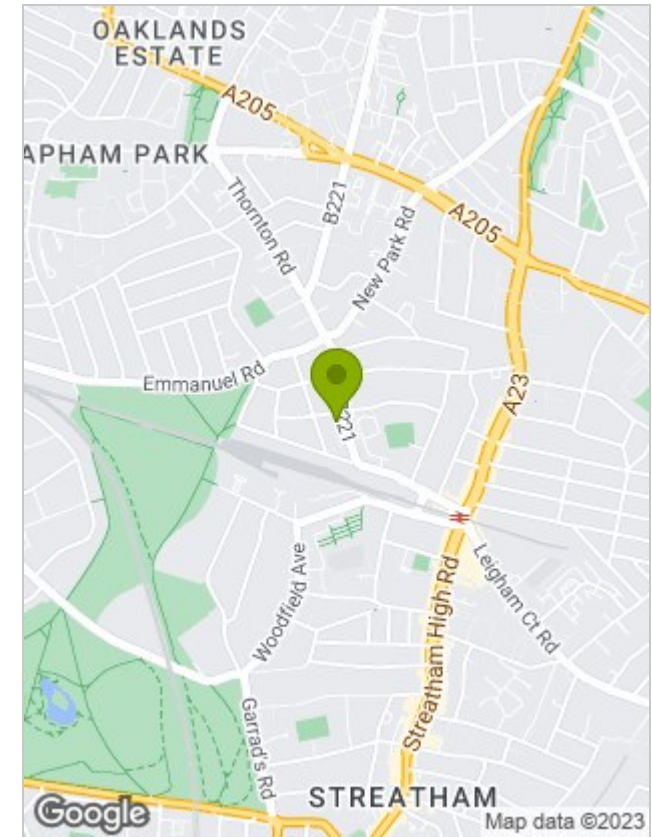

Energy Performance Graph



Viewing

Please contact our Chatterton Rees Office on 020 3780 0580 if you wish to arrange a viewing appointment for this property or require further information.

The particulars are set out as a general outline only for the guidance of intended purchasers or lessees, and do not constitute, any part of a contract. Nothing in these particulars shall be deemed to be a statement that the property is in good structural condition or otherwise nor that any of the services, appliances, equipment or facilities are in good working order. Purchasers should satisfy themselves of this prior to purchasing.